

# Outback Woodheater Range



## FAN FORCED HEATERS

### Barwon Pedestal

This huge unit with a powerful output heats up to 320 sq metres. Similar features to the Riverina and Barossa but a larger version. The huge glass window allows optimum viewing the night long. Brick lined with an 8mm steel baffle, the Barwon will impress.



### Barwon Insert

The same firebox as the Barwon pedestal. This contemporary looking heater is designed to heat 280 sq metres. With a deep ash bed burn chamber and an enormous door opening, this heater is easy to load and operate. An essential addition to a large family home.



# Specifications

## Clearances

MODEL	Rear Wall	Side Wall	Corners	Side Members	Top of appliance to underside of mantel	Top of appliance to breast plate	Back of heater to centre of flue
Riverina Pedestal	150mm	300mm	100mm	-	-	-	165mm
Barossa Pedestal	200mm	350mm	150mm	-	-	-	175mm
Barwon Pedestal	150mm	400mm	150mm	-	-	-	195mm
Riverina Insert Mk2	-	-	-	50mm	350mm	250mm	145mm
Barossa Insert Mk2	-	-	-	50mm	392mm	292mm	142mm
Barwon Insert Mk2	-	-	-	40mm	692mm	592mm	129mm
Homestead	175mm	350mm	75mm	-	-	-	165mm
Cottage	175mm	350mm	200mm	-	-	-	105mm
Sturt Pedestal	25mm	475mm	150mm	-	-	-	175mm

## Hearths (minimum sizes)

MODEL	Type	Size (Width x Depth x Thickness)
Riverina Pedestal	Full	1050mm x 1020mm x 12mm (400mm in front of heater base)
Barossa Pedestal	Full	1120mm x 950mm x 4.5mm (400mm in front of heater base)
Barwon Pedestal	Full	1170mm x 1125mm x 12mm (400mm in front of heater base)
Riverina Insert Mk2	Masonry	900mm x 450mm x 16mm (400mm in front of heater base)
Barossa Insert Mk2	Masonry	950mm x 450mm x 28mm (400mm in front of heater base)
Barwon Insert Mk2	Masonry	1020mm x 450mm x 25mm (400mm in front of heater base)
Homestead	Full	890mm x 1000mm x 9mm (350mm in front of heater base)
Cottage	Full	890mm x 1095mm x 12mm (350mm in front of heater base)
Sturt Pedestal	Full	765mm x 1000mm x 6mm (300mm in front of heater base)

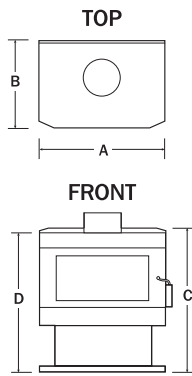

## Dimensions – Pedestal Heaters

MODEL	Dimensions (mm)				Flue Dia (mm)	Internal firebox size (mm)	Weight (kg)	Heating Capacity
	A	B	C	D				
Riverina	650	470	730	690	150	282 x 440	126	Up to 180m <sup>2</sup>
Barossa	720	570	790	760	150	347 x 500	165	Up to 260m <sup>2</sup>
Sturt	610	600	640	-	150	449 x 460	120	Up to 120m <sup>2</sup>
Barwon	792	572	870	830	175	347 x 572	183	Up to 320m <sup>2</sup>
Homestead	654	475	860	-	150	282 x 440	146	Up to 180m <sup>2</sup>
Cottage	650	570	825	-	150	282 x 440	180	Up to 120m <sup>2</sup>

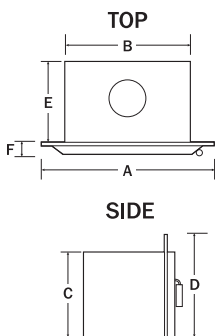

## Dimensions – Inserts

MODEL	Dimensions (mm)						Flue Dia (mm)	Internal Firebox size (mm)	Weight (kg)	Heating Capacity
	A	B	C	D	E	F				
Riverina Mk2	882	570	598	750	365	42	150	282 x 440	120	Up to 160m <sup>2</sup>
Barossa Mk2	922	630	638	758	430	42	150	347 x 500	140	Up to 240m <sup>2</sup>
Barwon Mk2	994	703	708	828	430	42	175	347 x 572	157	Up to 280m <sup>2</sup>



A Division of A.F. Gason Pty Ltd  
 Phone (613) 9729 7666 Fax (613) 9729 1455  
 Free Fax 1800 066 800  
 e-mail: sales@jindara.com.au  
 www.jindara.com.au



Your local Jindara dealer

# Jindara<sup>®</sup>

Heating

A Division of A.F. Gason Pty Ltd



Outback Woodheater Range

At the heart of all Jindara Outback certified woodheaters is a 100% Australian made durable steel firebox backed by our Ten Year Warranty. All models also have a large neo-ceramic self-cleaning door glass. Also included on the Riverina and Barossa models is a 3-speed fan to provide even faster warmth circulation. Certified to all relevant Australian standards, including the stringent AS-4013-1999 environmental emissions standard, accepted by all pollution control authorities, the range offers quality, style and outstanding performance, exactly as you would expect from a true Australian legend.

## FAN FORCED HEATERS

### Riverina Pedestal

The Riverina model is a compact yet powerful fan forced heater designed to heat small to medium homes of up to 180m<sup>2</sup>. Like all Jindara Heaters the Riverina possesses a heavy duty steel firebox fitted with firebrick liners to yield maximum performance, efficiency and protection. With its superior compact design the Riverina requires minimal floor space in your home.



### Riverina & Barossa Insert

If your home already possesses an open brick fireplace, or if you are building a home and wish to incorporate an open fire feel, you can now convert to clean burning, high efficiency combustion heating with the Jindara Riverina or Barossa Insert. Based on the successful pedestal units, these inserts allow you to achieve the best possible warmth for your family while not using up precious floor space in your home. Both inserts are designed to fit into an existing brick chimney and are fitted with a powerful 3 speed fan so the super heated air is transferred rapidly into your home for maximum efficiency. The Riverina insert will heat up to 160m<sup>2</sup>, the Barossa up to 260m<sup>2</sup>.





# Outback Woodheater Range



## FAN FORCED HEATERS

### Barossa Pedestal

Relax and enjoy the warmth of the magnificent Barossa. This huge, powerful, fan forced heater was designed to meet the requirements of larger homes in all of Australia's most severe winter conditions. Incorporating the stylish looks and innovative features of the smaller Riverina, the vast firebox of the Barossa will effortlessly heat your entire home all winter long. Enjoy the ambience of an all Australian crackling log fire in your home. Ideal to heat up to 260m<sup>2</sup>.



### Homestead

This attractive fan forced wood heater was designed for use in homes whilst offering a small wood storage area under the firebox. Enjoy the ambience of an all Australian crackling log fire in your home. Ideal to heat up to 180m<sup>2</sup>.



# Outback Woodheater Range



## RADIANT HEATERS

### Sturt Pedestal

For the budget conscious family or for those looking for a simple low cost form of heating while still maintaining the highest quality, Jindara has built a magnificent radiant style heater that combines technology, functionality and outstanding price. The Sturt is ideal for smaller homes, holiday homes and many other applications. The top of the Sturt makes an excellent surface for cooking as well. The Sturt includes the clean burning system common to all Jindara appliances, so you can rest assured that as you warm your family you are not harming our precious environment.



### Cottage

The Jindara Cottage can cook and heat simultaneously.

- Use the top of the cooker for pots and pans, whilst roasting in the very functional oven under the firebox.
- Easy to use controls to regulate the oven temperature.
- The firebox opening is at a convenient height for loading timber, and for viewing the dancing flames.
- Optional hot water booster can be used for even more versatility.

